



Grade 100 Toebehoren / Grade 100 Accessories

1. Topschalen /
Master links



2. Topschalen met verloopringen /
Master link assemblies



3. Verbindingschalen /
Connecting links



YE.10.079

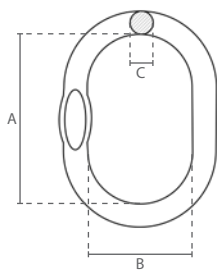

YE.10.080

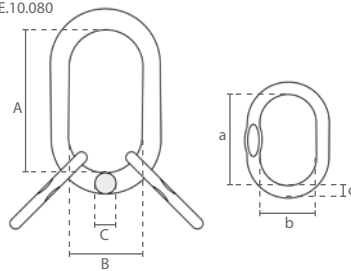

YE.10.015

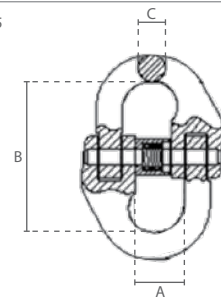

1 Specificaties / Specifications			Afmetingen / Dimensions (mm)		
Artikel nummer	Capaciteit / Capacity	Gewicht / Weight	A	B	C
Article code	ton	kg			
YE.10.079.08.06	2.50	0.4	120	70	14
YE.10.079.10.08	4.00	0.8	140	80	17
YE.10.079.13.10	7.50	1.5	160	95	22
YE.10.079.16.13	12.50	2.5	190	110	28
YE.10.079.20.16	17.00	5.2	240	140	34
YE.10.079.22.20	25.00	7.7	250	150	42
YE.10.079.26.22	30.80	12.9	340	180	45
YE.10.079.32.26	40.00	16.3	350	190	50
YE.10.079.36	60.00	27.0	400	200	60

2 Specificaties / Specifications			Afmetingen / Dimensions (mm)					
Artikel nummer	Capaciteit / Capacity	Gewicht / Weight	A	B	C	a	b	c
Article code	ton	kg						
YE.10.080.06	3.00	1.3	135	75	19	84	25	13
YE.10.080.08	5.30	2.4	160	90	23	70	35	17
YE.10.080.10	8.00	3.7	180	100	27	85	40	19
YE.10.080.13	14.00	6.5	200	110	33	115	50	23
YE.10.080.16	21.20	10.1	260	140	36	140	65	27
YE.10.080.20	33.60	22.8	350	190	50	150	70	33
YE.10.080.22	39.90	26.0	350	190	50	180	100	36

3 Specificaties / Specifications			Afmetingen / Dimensions (mm)		
Artikel nummer	Capaciteit / Capacity	Gewicht / Weight	A	B	C
Article code	ton	kg			
YE.10.015.06	1.40	0.1	14	45	8
YE.10.015.08	2.50	0.2	19	62	10
YE.10.015.10	4.00	0.4	23	72	13
YE.10.015.13	6.70	0.7	28	89	17
YE.10.015.16	10.00	1.2	34	103	21
YE.10.015.20	16.00	2.2	42	116	25
YE.10.015.22	19.00	3.0	48	135	27
YE.10.015.26	26.50	5.2	61	164	32
YE.10.015.32	39.30	9.5	80	194	40



Grade 100 Toebehoren / Grade 100 Accessories

4. Topschalen
met inkorthaak /
Master links
with grab hook

YE.10.050

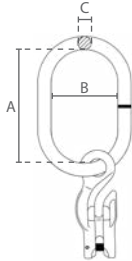
5. Topschalen
met inkorthaken /
Master links
with grab hooks

YE.10.051

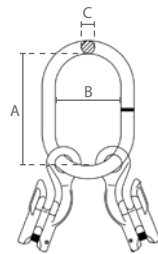
6. Topschalen
met inkorthaken /
Master links
with grab hooks

YE.10.052

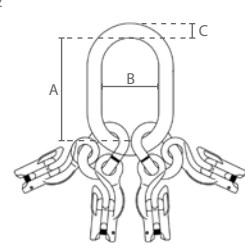

4 Specificaties / Specifications			Afmetingen / Dimensions (mm)		
Artikel nummer	Capaciteit / Capacity	Gewicht / Weight	A	B	C
Article code	ton	kg			
YE.10.050.06	1.40	0.7	110	60	13
YE.10.050.08	2.50	1.1	120	70	14
YE.10.050.10	4.00	2.1	140	80	17
YE.10.050.13	6.70	3.9	160	95	22
YE.10.050.16	10.00	6.8	190	110	25
YE.10.050.20	16.00	13.5	230	130	32

5 Specificaties / Specifications			Afmetingen / Dimensions (mm)		
Artikel nummer	Capaciteit / Capacity	Gewicht / Weight	A	B	C
Article code	ton	kg			
YE.10.051.06	2.00	1.1	120	70	14
YE.10.051.08	3.55	2.1	140	80	17
YE.10.051.10	5.60	4.2	160	95	22
YE.10.051.13	9.50	7.0	190	110	25
YE.10.051.16	14.00	13.5	230	130	32

6 Specificaties / Specifications			Afmetingen / Dimensions (mm)		
Artikel nummer	Capaciteit / Capacity	Gewicht / Weight	A	B	C
Article code	ton	kg			
YE.10.052.06	3.00	2.5	135	75	19
YE.10.052.08	5.30	5.2	160	90	23
YE.10.052.10	8.00	9.3	180	100	27
YE.10.052.13	14.00	16.1	200	110	33
YE.10.052.16	21.20	28.1	260	140	36
YE.10.052.20	33.50	60.2	350	190	50

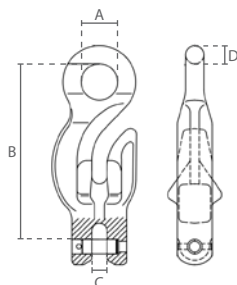

Specificaties / Specifications		Afmetingen / Dimensions (mm)			
Capaciteit / Capacity	Gewicht / Weight	A	B	C	D
ton	kg				
1.40	0.3	18	88	8	9
2.50	0.7	24	116	12	12
4.00	1.4	30	145	12	15
6.70	2.4	37	178	15	18
10.00	4.5	45	216	19	22
16.00	9.0	58	278	24	28



Grade 100 Toebehoren / Grade 100 Accessories

7. Gaffelhaken met klep /
Clevis hooks with latch



8. Ooghaken met klep /
Eye hooks with latch



9. Veiligheids gaffelhaken /
Self-locking clevis hooks

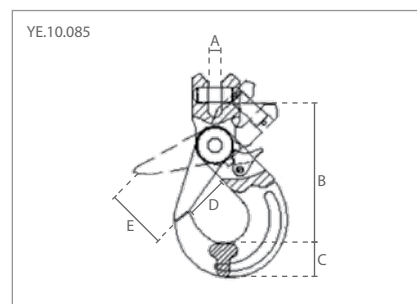
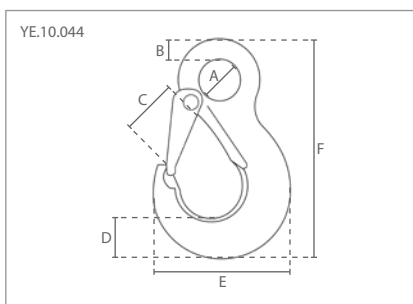
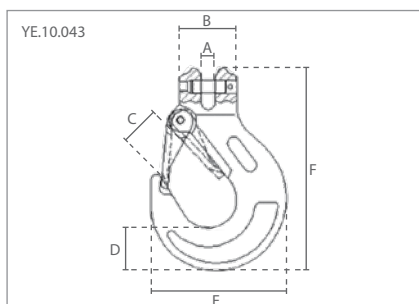

7 Specificaties / Specifications			Afmetingen / Dimensions (mm)					
Artikel nummer	Capaciteit / Capacity	Gewicht / Weight	A	B	C	D	E	F
Article code	ton	kg						
YE.10.043.06	1.40	0.4	8	32	19	21	69	109
YE.10.043.08	2.50	0.7	10	37	25	28	88	134
YE.10.043.10	4.00	1.3	12	48	28	34	106	162
YE.10.043.13	6.70	2.3	15	59	38	42	134	203
YE.10.043.16	10.00	3.6	18	70	44	50	161	248
YE.10.043.20	16.00	7.3	25	85	52	56	191	297
YE.10.043.22	19.00	12.1	27	100	66	62	215	326

8 Specificaties / Specifications			Afmetingen / Dimensions (mm)					
Artikel nummer	Capaciteit / Capacity	Gewicht / Weight	A	B	C	D	E	F
Article code	ton	kg						
YE.10.044.06	1.40	0.3	21	10	19	21	70	111
YE.10.044.08	2.50	0.6	25	11	25	28	86	138
YE.10.044.10	4.00	1.2	34	16	28	33	105	172
YE.10.044.13	6.70	2.2	43	19	38	44	132	219
YE.10.044.16	10.00	3.5	50	25	44	50	160	260
YE.10.044.20	16.00	7.2	55	27	52	56	190	298
YE.10.044.22	19.00	11.5	60	29	66	62	214	330
YE.10.044.26	26.50	12.2	70	35	73	75	245	376
YE.10.044.32	39.30	17.5	82	39	87	89	270	458

9 Specificaties / Specifications			Afmetingen / Dimensions (mm)				
Artikel nummer	Capaciteit / Capacity	Gewicht / Weight	A	B	C	D	E
Article code	ton	kg					
YE.10.085.06	1.40	0.50	8	96	20	28	35
YE.10.085.20	16.00	8.6	25	235	62	77	80
YE.10.085.22	19.00	12.1	26	277	66	80	83



Grade 100 Toebehoren / Grade 100 Accessories

7. Gaffelhaken met klep /
Clevis hooks with latch



8. Ooghaken met klep /
Eye hooks with latch



9. Veiligheids gaffelhaken /
Self-locking clevis hooks

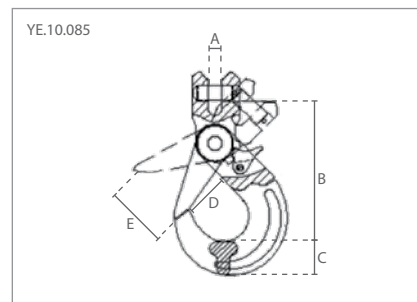
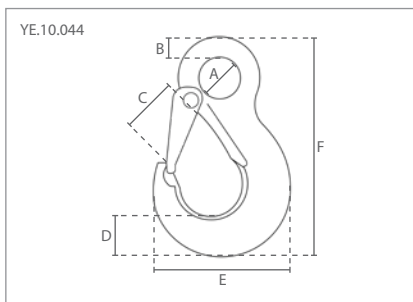
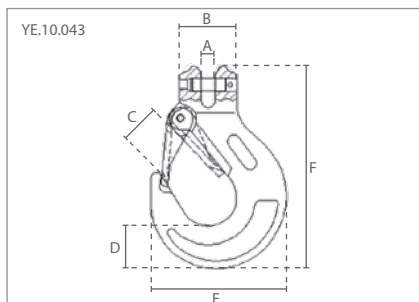

7 Specificaties / Specifications			Afmetingen / Dimensions (mm)					
Artikel nummer	Capaciteit / Capacity	Gewicht / Weight	A	B	C	D	E	F
Article code	ton	kg						
YE.10.043.06	1.40	0.4	8	32	19	21	69	109
YE.10.043.08	2.50	0.7	10	37	25	28	88	134
YE.10.043.10	4.00	1.3	12	48	28	34	106	162
YE.10.043.13	6.70	2.3	15	59	38	42	134	203
YE.10.043.16	10.00	3.6	18	70	44	50	161	248
YE.10.043.20	16.00	7.3	25	85	52	56	191	297
YE.10.043.22	19.00	12.1	27	100	66	62	215	326

8 Specificaties / Specifications			Afmetingen / Dimensions (mm)					
Artikel nummer	Capaciteit / Capacity	Gewicht / Weight	A	B	C	D	E	F
Article code	ton	kg						
YE.10.044.06	1.40	0.3	21	10	19	21	70	111
YE.10.044.08	2.50	0.6	25	11	25	28	86	138
YE.10.044.10	4.00	1.2	34	16	28	33	105	172
YE.10.044.13	6.70	2.2	43	19	38	44	132	219
YE.10.044.16	10.00	3.5	50	25	44	50	160	260
YE.10.044.20	16.00	7.2	55	27	52	56	190	298
YE.10.044.22	19.00	11.5	60	29	66	62	214	330
YE.10.044.26	26.50	12.2	70	35	73	75	245	376
YE.10.044.32	39.30	17.5	82	39	87	89	270	458

9 Specificaties / Specifications			Afmetingen / Dimensions (mm)				
Artikel nummer	Capaciteit / Capacity	Gewicht / Weight	A	B	C	D	E
Article code	ton	kg					
YE.10.085.06	1.40	0.50	8	96	20	28	35
YE.10.085.20	16.00	8.6	25	235	62	77	80
YE.10.085.22	19.00	12.1	26	277	66	80	83



Grade 100 Toebehoren / Grade 100 Accessories

10. Veiligheids gaffelhaken
met grip /
Self-locking clevis hooks
with grip



11. Veiligheids ooghaken /
Self-locking eye hooks



12. Veiligheids ooghaken
met grip /
Self-locking eye hooks
with grip



YE.10.085

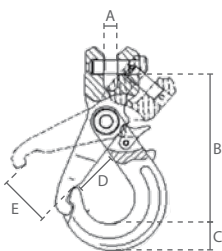

YE.10.025

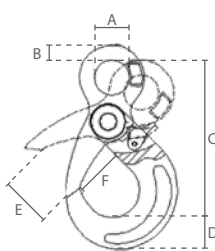

YE.10.025

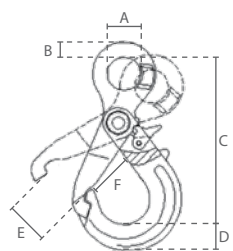

10 Specificaties / Specifications			Afmetingen / Dimensions (mm)					
Artikel nummer	Capaciteit / Capacity	Gewicht / Weight	A	B	C	D	E	
Article code	ton	kg						
YE.10.085.08	2.50	0.9	10	123	26	36	40	
YE.10.085.10	4.00	1.6	12	144	30	45	50	
YE.10.085.13	6.70	2.9	15	182	41	54	60	
YE.10.085.16	10.00	5.8	18	217	51	62	65	
11 Specificaties / Specifications			Afmetingen / Dimensions (mm)					
Artikel nummer	Capaciteit / Capacity	Gewicht / Weight	A	B	C	D	E	F
Article code	ton	kg						
YE.10.025.20	16.00	7.9	60	30	277	62	80	77
YE.10.025.22	19.00	11.2	70	31	320	66	83	80
12 Specificaties / Specifications			Afmetingen / Dimensions (mm)					
Artikel nummer	Capaciteit / Capacity	Gewicht / Weight	A	B	C	D	E	F
Article code	ton	kg						
YE.10.025.08	2.50	0.9	27	12	137	26	35	36
YE.10.025.10	4.00	1.5	35	14	169	30	46	45
YE.10.025.13	6.70	2.7	40	20	209	41	56	54
YE.10.025.16	10.00	5.7	50	26	254	51	64	62



Grade 100 Toebehoren / Grade 100 Accessories

**13. Veiligheids wartelhaken /
Self-locking swivel hooks**
(Onbelast wartelen / Swivel without load)



**14. Veiligheids wartelhaken
met grip /
Self-locking swivel hooks
with grip**
(Onbelast wartelen / Swivel without load)



**15. Veiligheids wartelhaken
met lager /
Self-locking swivel hooks
with bearing**
(Belast wartelen / Swivel with load)

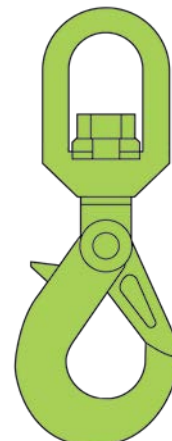

YE.10.086

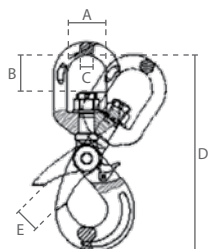

YE.10.086

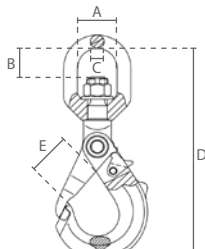

YE.10.089

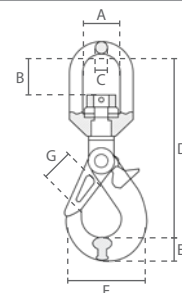

13 Specificaties / Specifications			Afmetingen / Dimensions (mm)				
Artikel nummer	Capaciteit / Capacity	Gewicht / Weight					
Article code	ton	kg	A	B	C	D	E
YE.10.086.06	1.40	0.6	33	23	12	184	28
YE.10.086.20	16.00	12.5	72	62	26	463	77
YE.10.086.22	19.00	17.1	97	94	33	572	80

14 Specificaties / Specifications			Afmetingen / Dimensions (mm)				
Artikel nummer	Capaciteit / Capacity	Gewicht / Weight					
Article code	ton	kg	A	B	C	D	E
YE.10.086.08	2.50	1.1	36	28	13	229	36
YE.10.086.10	4.00	2.0	42	35	16	269	45
YE.10.086.13	6.70	4.0	50	40	17	330	54
YE.10.086.16	10.00	6.8	61	56	22	413	62

15 Specificaties / Specifications			Afmetingen / Dimensions (mm)						
Artikel nummer	Capaciteit / Capacity	Gewicht / Weight							
Article code	ton	kg	A	B	C	D	E	F	G
YE.10.089.06	1.40	0.7	37	32	13	163	19	70	27
YE.10.089.08	2.50	1.2	41	39	15	202	25	90	36
YE.10.089.10	4.00	2.2	48	48	18	244	27	108	45
YE.10.089.13	6.70	4.4	55	57	19	292	41	138	53
YE.10.089.16	10.00	7.5	62	62	26	346	49	170	62
YE.10.089.20	16.00	13.8	76	72	29	396	64	191	76



Grade 100 Toebehoren / Grade 100 Accessories

16. Gaffel inkorthaken /
Clevis grab hooks



17. Gaffel inkorthaken
met veiligheidspin /
Clevis grab hooks
with safety pin



18. Oog inkorthaken /
Eye grab hooks

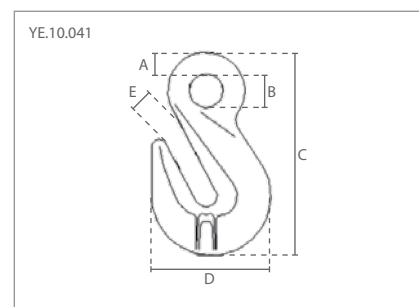
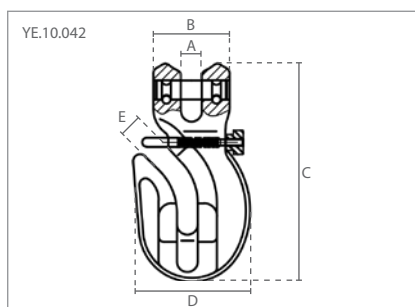
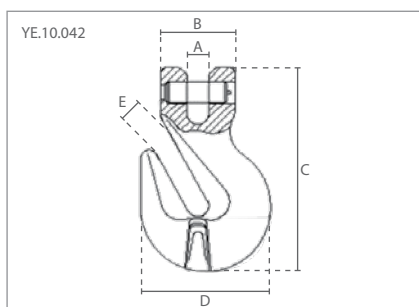

16 Specificaties / Specifications			Afmetingen / Dimensions (mm)				
Artikel nummer	Capaciteit / Capacity	Gewicht / Weight	A	B	C	D	E
Article code	ton	kg					
YE.10.042.06	1.40	0.3	8	32	75	44	8
YE.10.042.16	10.00	2.9	18	70	184	113	20
YE.10.042.20	16.00	4.9	24	85	224	143	24
YE.10.042.22	19.00	8.3	27	100	262	161	27

17 Specificaties / Specifications			Afmetingen / Dimensions (mm)				
Artikel nummer	Capaciteit / Capacity	Gewicht / Weight	A	B	C	D	E
Article code	ton	kg					
YE.10.042.08	2.50	0.5	17	35	110	50	11
YE.10.042.10	4.00	1.0	21	43	137	71	14
YE.10.042.13	6.70	2.2	28	63	180	90	16

18 Specificaties / Specifications			Afmetingen / Dimensions (mm)				
Artikel nummer	Capaciteit / Capacity	Gewicht / Weight	A	B	C	D	E
Article code	ton	kg					
YE.10.041.06	1.40	0.2	10	15	71	44	8
YE.10.041.16	10.00	2.5	23	36	183	113	20
YE.10.041.20	16.00	4.7	26	44	227	143	24
YE.10.041.22	19.00	8.3	34	49	261	161	27



Grade 100 Toebehoren / Grade 100 Accessories

19. Oog inkorthaken
met veiligheidspin /
Eye grab hooks
with safety pin

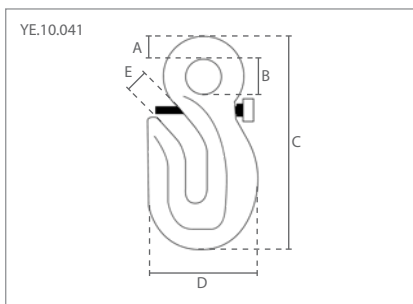

19 Specificaties / Specifications			Afmetingen / Dimensions (mm)				
Artikel nummer	Capaciteit / Capacity	Gewicht / Weight	A	B	C	D	E
	ton	kg					
YE.10.041.08	2.50	0.5	12	17	110	53	11
YE.10.041.10	4.00	1.0	15	21	137	72	14
YE.10.041.13	6.70	2.2	21	28	180	96	16

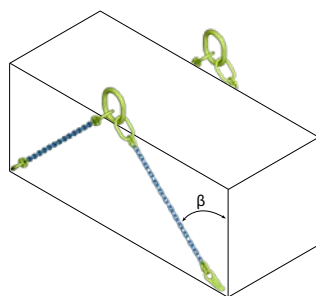

Grade 100 Toebehoren / Grade 100 Accessories

20. Containerhaken /
Container hooks21. Zeecontainerhaken /
Sea container hooks
(2x links/left + 2x rechts/right)22. Containerhaken /
Container hooks

Specificaties / Specifications	
β	Container gewicht / weight (ton)
< 30°	niet toegestaan / not allowed
30°	55.00
45°	45.00
60°	32.00
> 60°	niet toegestaan / not allowed

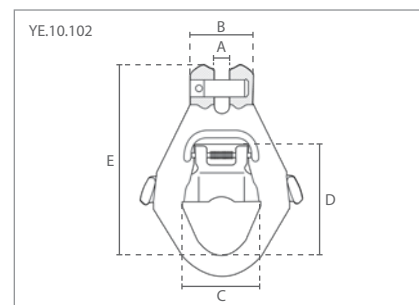
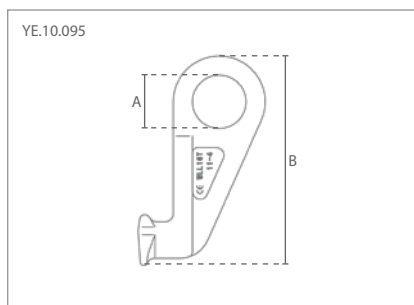
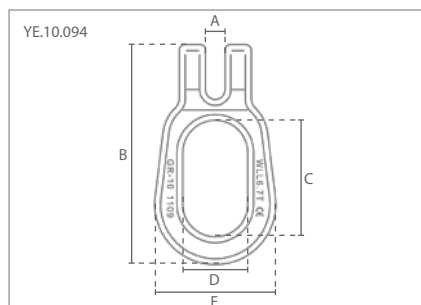

Specificaties / Specifications			Afmetingen / Dimensions (mm)				
Artikel nummer	Capaciteit / Capacity	Gewicht / Weight	A	B	C	D	E
Article code	ton	kg					
YE.10.094.13	6.70	1.3	15	174	90	50	93

Specificaties / Specifications			Afmetingen / Dimensions (mm)	
Artikel nummer	Capaciteit / Capacity	Gewicht / Weight	A	B
Article code	ton	kg		
YE.10.095.19	16.00	4.3	69	283

Specificaties / Specifications			Afmetingen / Dimensions (mm)				
Artikel nummer	Capaciteit / Capacity	Gewicht / Weight	A	B	C	D	E
Article code	ton	kg					
YE.10.102.13	6.70	1.9	27	60	72	104	195